

SIS

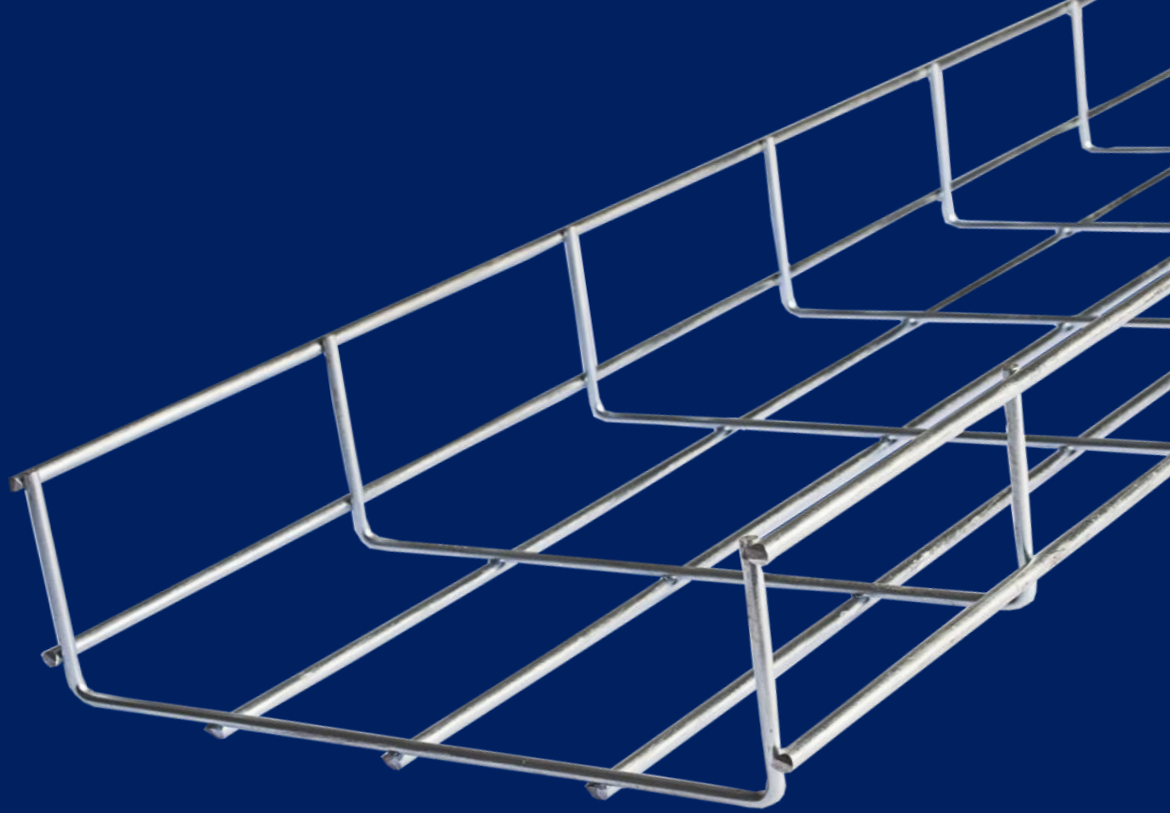

Wire Mesh Cable Trays & Products





Energizing The World That Demands More.



SIS as a global management company, we help Customers worldwide manage the power Needed for building Data Centres, Industrial Plants, Food & Dairy, Pharmaceuticals, Architectural Buildings and more.

SIS Cable trays innovative technology helps customers Manage electrical, hydraulic, and machine power More reliably, efficiently, safely and sustainably.

We provide integrated solutions that seamlessly Help in cable management systems in all its forms, More practical and accessible .

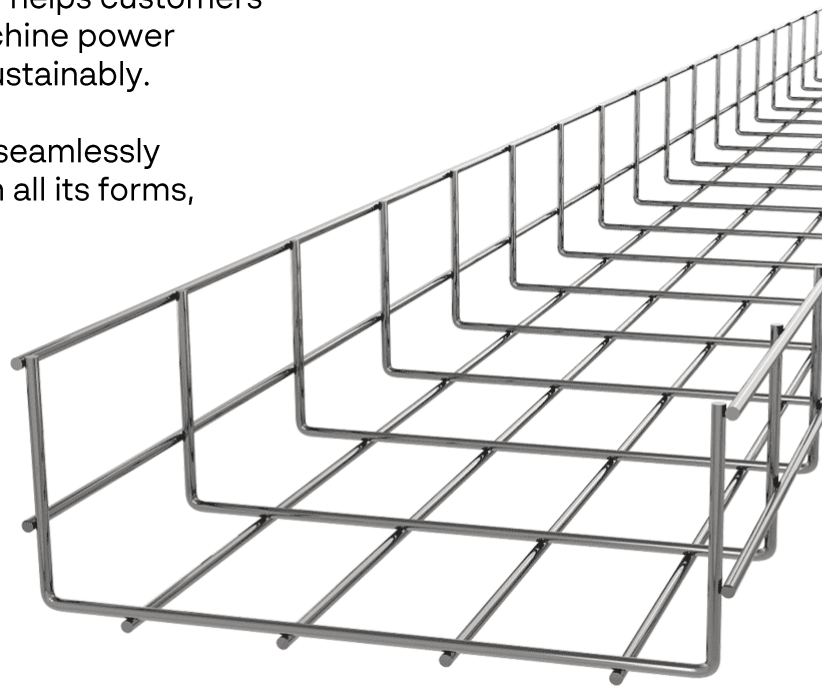

Wire Mesh Cable Tray Technical Guide

Finish Information

SIS cable tray and accessories are available in a wide variety of finishes to meet the environmental or aesthetic requirements of customer installations. Use the list below to find the finish and suffix that will meet your needs.

Available product finishes will be listed on individual pages throughout the catalogue. Finish codes shown in bold type are the standard for that product.

Plain wire: ASTM A510, Grade 1008

- EG** Electroplated zinc galvanized finish applied after fabrication
(ELG) Recommended applications: Controlled interior
UL/CSA Classified as an equipment ground conductor when spliced as recommended ASTM B633 - Average thickness of 0.3 mils (8 microns)
- GS** Pre-galvanized zinc finish applied before fabrication
(GLV) Recommended applications: Limited industrial & interior
UL/CSA Classified as an equipment ground conductor when spliced as recommended ASTM A641
- BLE** Black powder coat finish applied after fabrication
Recommended applications:
Controlled interior
UL/CSA Classified as an equipment ground conductor when coating has been removed at splice contact points
Average paint thickness of 1.2 mils (30 microns) to 3.0 mils (75 microns)
- HD** Hot dip galvanized finish applied after fabrication
(HDG) Recommended applications: Exterior, corrosive. Not intended for clean room applications.
UL/CSA Classified as an equipment ground conductor when spliced as recommended ASTM A123 - Average thickness of 2.4 mils (60 microns) to 3.2 mils (80 microns)
- 304S** 304L Stainless steel
(SS4) Recommended applications: Food preparation, wash-down areas ASTM A580
- 316S** 316L Stainless steel
(SS6) Recommended applications: Highly corrosive applications & marine environments ASTM A580
Custom powder coat finish applied after fabrication
Recommended applications: Controlled interior
UL/CSA Classified as an equipment ground conductor when coating has been removed at splice contact points
No Specification

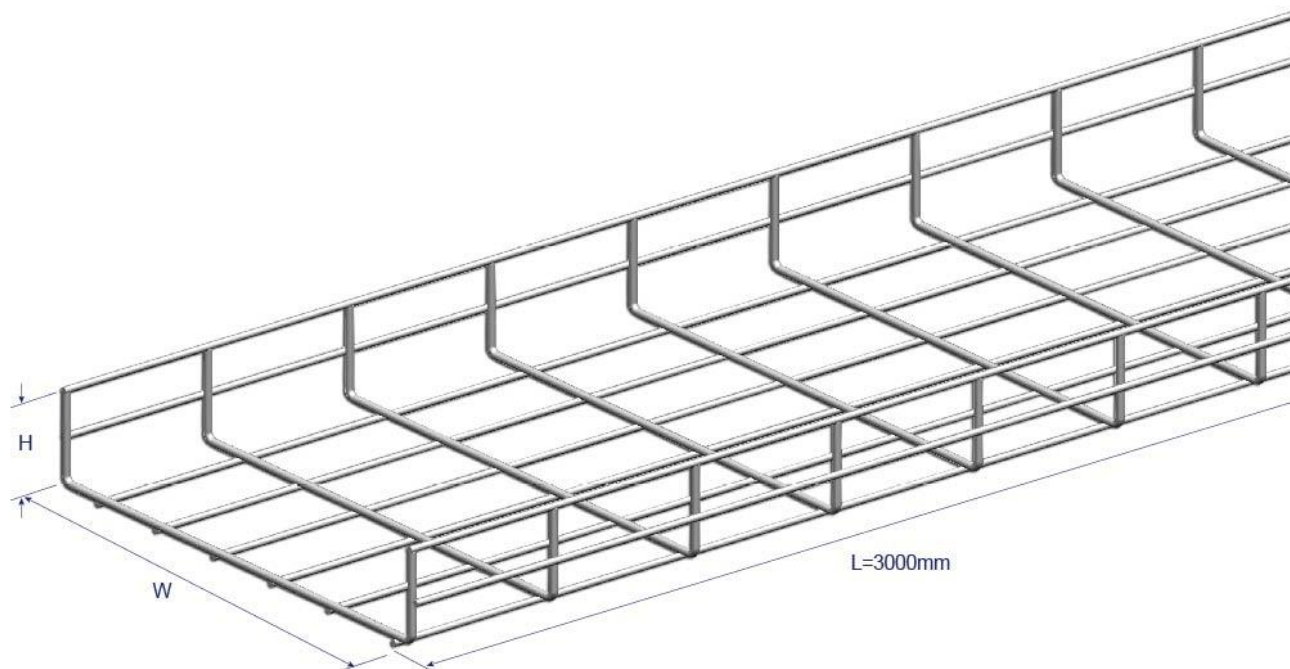

BM2 Wire Mesh Cable Tray

BM1/2/3 Wire Mesh Cable Tray

Ordering Code	W (mm)	H (mm)	L (mm)
BM1-50Z	50	35	3000
BM1-100Z	100	35	3000
BM1-150Z	150	35	3000
BM1-200Z	200	35	3000
BM1-250Z	250	35	3000
BM1-300Z	300	35	3000
BM1-450Z	450	35	3000
BM1-600Z	600	35	3000
BM2-50Z	50	50	3000
BM2-100Z	100	50	3000
BM2-150Z	150	50	3000
BM2-200Z	200	50	3000
BM2-250Z	250	50	3000
BM2-300Z	300	50	3000
BM2-450Z	450	50	3000
BM2-600Z	600	50	3000
BM3-100Z	100	100	3000
BM3-150Z	150	100	3000
BM3-200Z	200	100	3000
BM3-250Z	250	100	3000
BM3-300Z	300	100	3000
BM3-450Z	450	100	3000
BM3-500Z	500	100	3000
BM3-600Z	600	100	3000

BM-SB Straight Bracket

Ordering Code	W (mm)	A (mm)
BM-SB50Z	50	150
BM-SB100Z	100	200
BM-SB150Z	150	250
BM-SB200Z	200	300
BM-SB250Z	250	350
BM-SB300Z	300	400
BM-SB450Z	450	550
BM-SB600Z	600	700

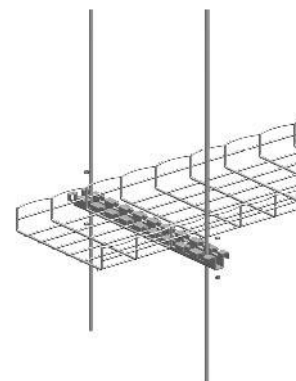
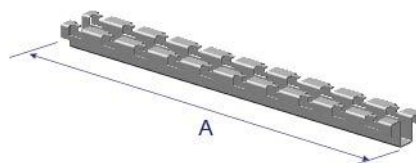

BM-SB Straight Bracket

BM-SWB Strengthen Wall Bracket

Ordering Code	W (mm)	A (mm)
BM-SWB50Z	50	100
BM-SWB100Z	100	150
BM-SWB150Z	150	200
BM-SWB200Z	200	250
BM-SWB250Z	250	300
BM-SWB300Z	300	350
BM-SWB450Z	450	500
BM-SWB600Z	600	650

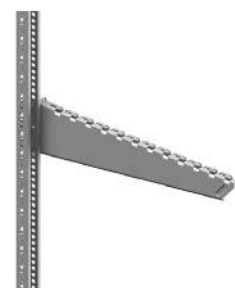
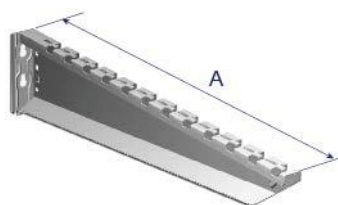

BM-SWB Strengthen Wall Bracket

BM-LB L Bracket

Ordering Code	W (mm)	A (mm)
BM-LB50Z	50	100
BM-LB100Z	100	150
BM-LB150Z	150	200
BM-LB200Z	200	250
BM-LB250Z	250	300
BM-LB300Z	300	350
BM-LB450Z	450	500
BM-LB600Z	600	650

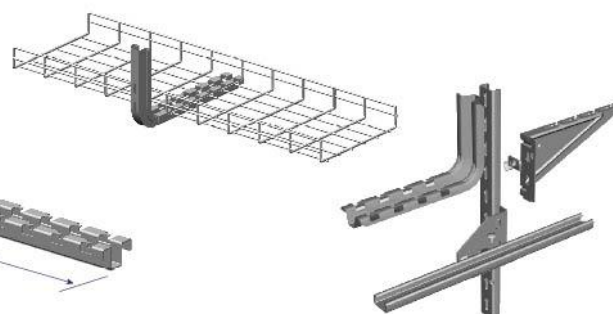
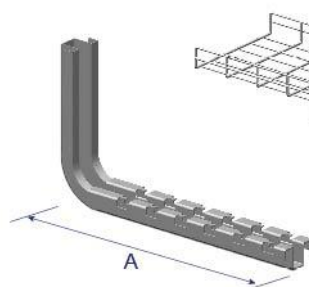

BM-LB L Bracket

BM-UB U Bracket

Ordering Code	W (mm)	A (mm)
BM-UB50Z	50	100
BM-UB100Z	100	150
BM-UB150Z	150	200
BM-UB200Z	200	250
BM-UB250Z	250	300
BM-UB300Z	300	350
BM-UB450Z	450	500
BM-UB600Z	600	650

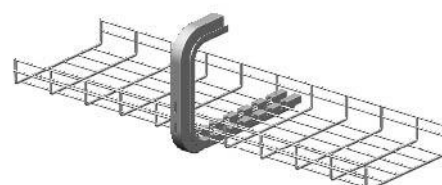
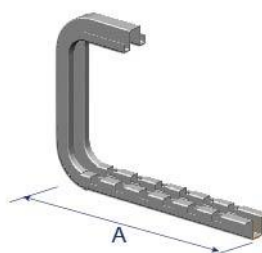

BM-UB U Bracket

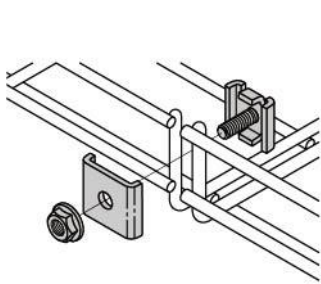

WB4CA Connector Assembly

Ordering Code

WB4CA

WB4CA Connector Assembly

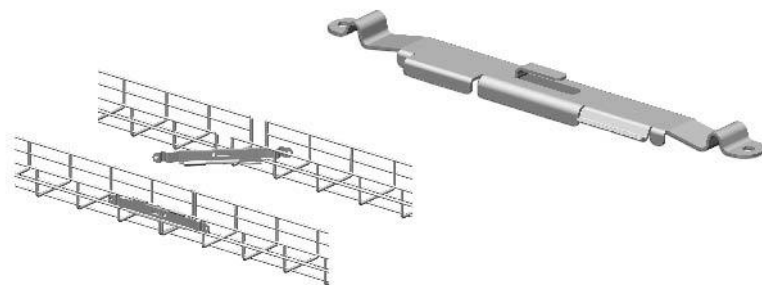

WB-TLC Faster Connector

Ordering Code

WB-TLC

WB-TLC Faster Connector

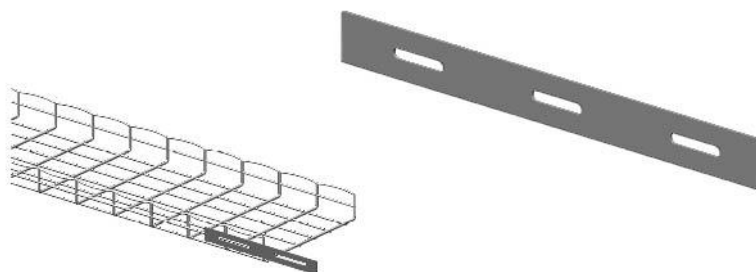

BM-SBS Splice Bar (Short)

Ordering Code

BM-SBS

BM-SBS Splice Bar (Short)

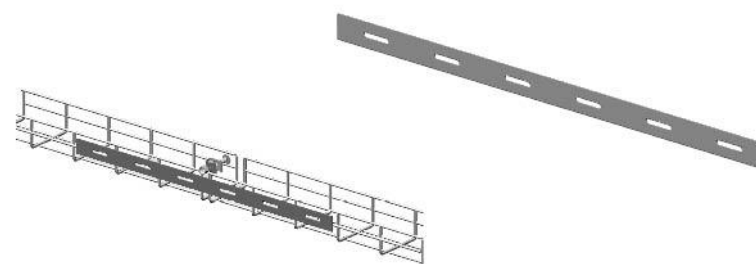

BM-SBL Splice Bar (Long)

Ordering Code

BM-SBL

BM-SBL Splice Bar (Long)

Z Zinc Plated

H Hot Dip Galvanized / HDG

S4 Stainless Steel SS304

S6 Stainless Steel SS316

P Powder Coated

M Mill / Plain Steel

BM-TSB Tee Splice Bar

Ordering Code

BM-TSB

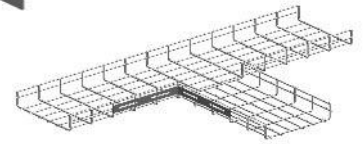
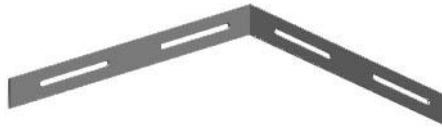

BM-TSB Tee Splice Bar

BM-HDP Hold Down Plate

Ordering Code

BM-HDP

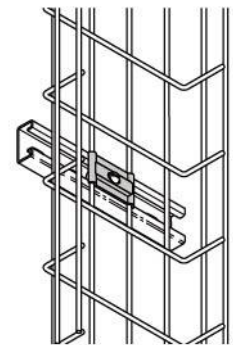
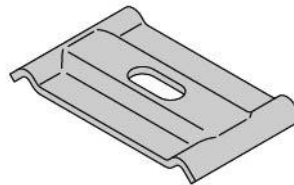

BM-HDP Hold Down Plate

BM-WB Wall Bracket

Ordering Code

BM-WB

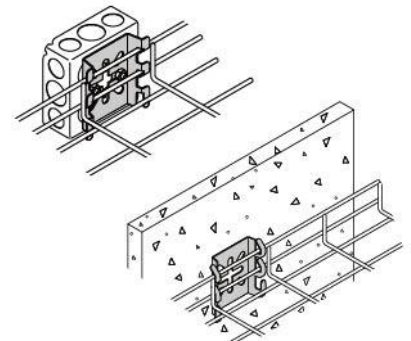
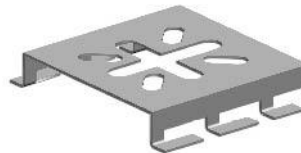

BM-WB Wall Bracket

BM-OHL Overhead Hanger Clip

Ordering Code

BM-OHL

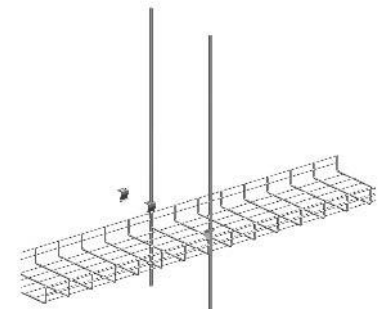

BM-OHL Overhead Hanger Clip

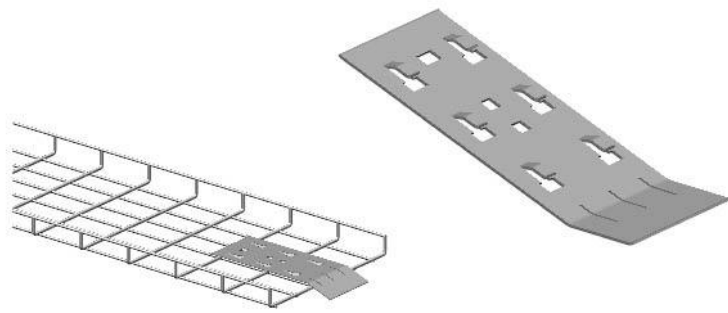

BM-DO Drop-out

BM-DO Drop-out

Ordering Code

BM-DO

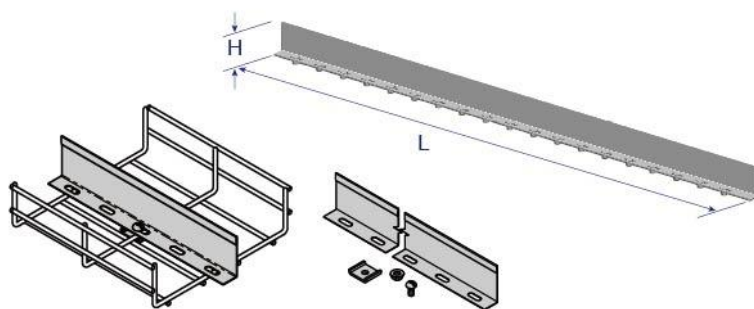

BM*-B Barriers

BM*-B Barriers

Ordering Code	H (mm)	L (mm)
BM4-B	35	3000
BM5-B	50	3000
BM6-B	100	3000

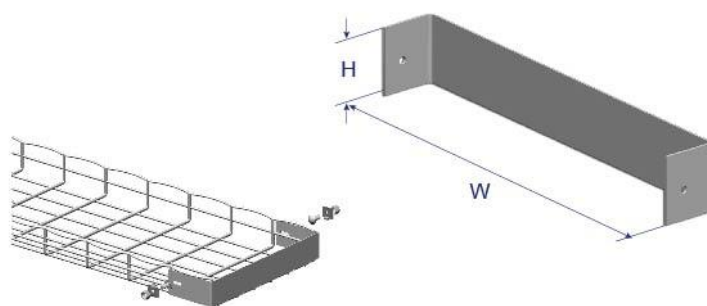

BM*-BE Blind End

BM*-BE Blind End

Ordering Code	W (mm)	H (mm)
BM5-BE50	50	50
BM5-BE100	100	50
BM5-BE150	150	50
BM5-BE200	200	50
BM5-BE250	250	50
BM5-BE300	300	50
BM5-BE450	450	50
BM5-BE600	600	50

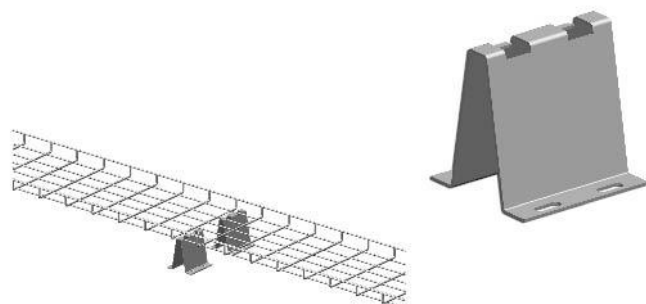

BM-UFS Under Floor Stand

BM-UFS Under Floor Stand

Ordering Code

BM-UFS

BM-GC Grounding Clamp

Ordering Code

BM-GC

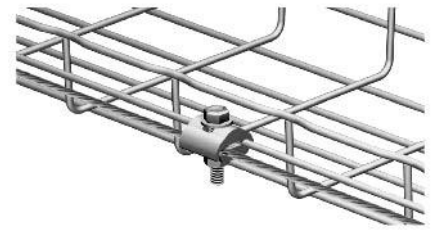

BM-GC Grounding Clamp

BM-CC Conduit Connector

Ordering Code Conduit Size

BM-CC050	1/2"
BM-CC075	3/4"
BM-CC100	1"
BM-CC125	1 1/4"
BM-CC150	1 1/2"
BM-CC200	2"

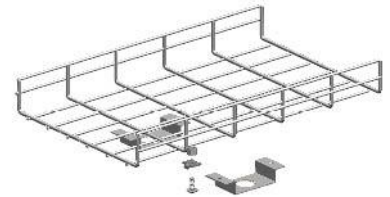
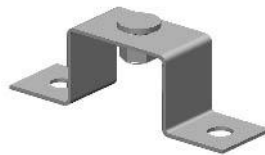

BM-CC Conduit Connector

BM-P Pan

Ordering Code W (mm) L (mm)

BM-P50	50	3000
BM-P100	100	3000
BM-P150	150	3000
BM-P200	200	3000
BM-P250	250	3000
BM-P300	300	3000
BM-P450	450	3000
BM-P600	600	3000

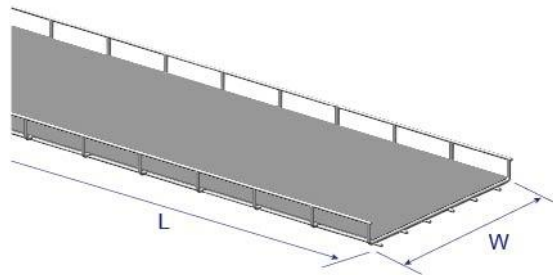

BM-P Pan

HDHS Heavy Duty Hang Support Kit

Ordering Code W (mm) A (mm)

HDHS50	50	100
HDHS100	100	150
HDHS150	150	200
HDHS200	200	250
HDHS250	250	300
HDHS300	300	350
HDHS450	450	500
HDHS600	600	650

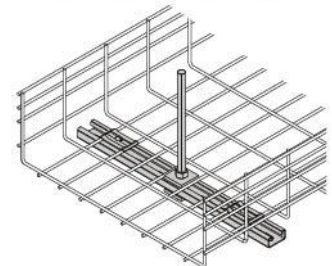
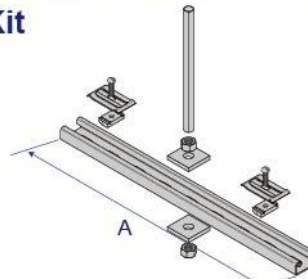

HDHS Heavy Duty Hang Support Kit

W: Width of Wire Mech Cable Tray
A: Length of HDHS (UFSB)

UFSB Under Floor Support Bracket

Ordering Code W (mm) A (mm)

UFSB50	50	100
UFSB100	100	150
UFSB150	150	200
UFSB200	200	250
UFSB250	250	300
UFSB300	300	350
UFSB450	450	500
UFSB600	600	650

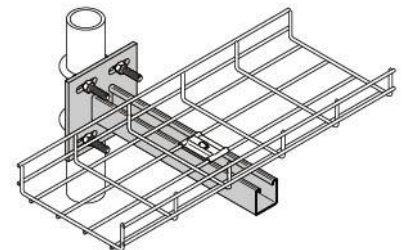
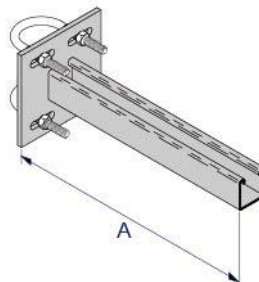

UFSB Under Floor Support Bracket

W: Width of Wire Mech Cable Tray
A: Length of HDHS (UFSB)

SIS

Wire Mesh Cable Trays & Products

Standard Industrial Store
1/9B Asaf Ali Road
New Delhi-110002, India
Phone: (91) 9311741747

AN ISO 9001:2015 IAF CERTIFIED COMPANY